



AC Reversible Motor 6W



List of Motor Characteristics

| Model of Motor | | Output | Voltage | Frequency | Poles | Duty | Rated | | | | Starting Torque | | Capacitor/ve |
|----------------|-----------------------|--------|---------|-----------|-------|-------|-------|---------|--------|--------|-----------------|--------|--------------|
| Motor | Motor with gear shaft | W | V | Hz | P | | Speed | Current | Torque | | N.m | kgf.cm | μF/VAC |
| | | | | | | | r/min | A | N.m | kgf.cm | | | |
| 2RK6A-A | 2RK6GN-A | 6 | 1ph110 | 50 | 4 | 30Min | 1250 | 0.22 | 0.05 | 0.45 | 0.06 | 0.60 | 3.5/250 |
| 2RK6A-C | 2RK6GN-C | 6 | 1ph220 | 50 | 4 | 30Min | 1250 | 0.11 | 0.05 | 0.45 | 0.06 | 0.60 | 1.0/450 |

■The capacitor capacitance will be different under different voltage. A correct capacitor capacitance is required to match the applied voltage. ■Wrong capacitor capacitance is the cause of trouble. You must confirm a correct voltage and select a correct model when your purchase order is placed.

Overall Dimension of Gearbox

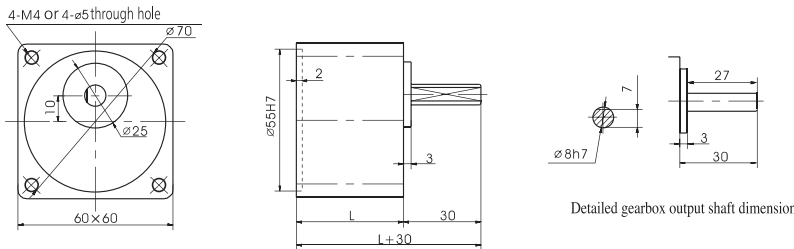

| | Reduction Ratio | L(mm) | Weight (kg) |
|---------|-----------------|-------|-------------|
| Gearbox | 2GN3K-GN18K | 32 | 0.24 |
| | 2GN20K-GN50K | 42 | 0.30 |
| | 2GN60K-GN200K | | 0.33 |
| Motor | | | 0.71 |

Allowable Torque on Gearbox

Model of Gearbox:2GN□K

| Frequency | Reduction Ratio | | 3 | 3.6 | 5 | 6 | 7.5 | 9 | 10 | 12.5 | 15 | 18 | 20 | 25 | 30 | 36 | 40 | 50 | 60 | 75 | 90 | 100 | 120 | 150 |
|-----------|--------------------|--------|------|------|------|------|------|------|------|------|------|------|------|------|------|------|------|------|------|------|------|------|------|------|
| 50Hz | Output Shaft Speed | r/min | 500 | 417 | 300 | 250 | 200 | 166 | 150 | 120 | 100 | 83 | 75 | 60 | 50 | 41 | 37 | 30 | 25 | 20 | 16 | 15 | 12 | 10 |
| | Allowable Torque | N.m | 0.13 | 0.15 | 0.21 | 0.26 | 0.31 | 0.38 | 0.42 | 0.53 | 0.63 | 0.76 | 0.76 | 0.95 | 1.14 | 1.36 | 1.52 | 1.72 | 2.06 | 2.57 | 2.94 | 2.94 | 2.94 | 2.94 |
| | | kgf.cm | 1.3 | 1.5 | 2.1 | 2.6 | 3.2 | 3.9 | 4.3 | 5.4 | 6.4 | 7.7 | 7.7 | 9.7 | 11.6 | 13.9 | 15.5 | 17.5 | 21.0 | 26.2 | 30.0 | 30.0 | 30.0 | 30.0 |
| 60Hz | Output Shaft Speed | r/min | 600 | 500 | 360 | 360 | 240 | 200 | 180 | 144 | 120 | 100 | 80 | 72 | 60 | 50 | 45 | 36 | 30 | 24 | 20 | 18 | 15 | 12 |
| | Allowable Torque | N.m | 0.10 | 0.13 | 0.17 | 0.21 | 0.26 | 0.30 | 0.34 | 0.43 | 0.51 | 0.62 | 0.62 | 0.76 | 0.92 | 1.11 | 1.24 | 1.39 | 1.67 | 2.09 | 2.50 | 2.78 | 2.94 | 2.94 |
| | | kgf.cm | 1.0 | 1.3 | 1.7 | 2.1 | 2.6 | 3.1 | 3.5 | 4.4 | 5.2 | 6.3 | 6.3 | 7.8 | 9.4 | 11.3 | 12.6 | 14.2 | 17.0 | 21.3 | 25.5 | 28.4 | 30.0 | 30.0 |

Capacitor

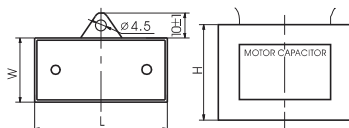

| capacity μF | Voltage | L±1 | W±1 | H±1 | Type |
|------------------------|---------|-----|-----|-----|-----------|
| Allowable Deviation±5% | V | mm | mm | mm | Down-lead |
| 1.0 | 450 | 37 | 14 | 28 | |
| 3.5 | 250 | 47 | 22 | 34 | |

Model of Gearbox:2GN□K

| Frequency | Reduction Ratio | | 180 | 200 |
|-----------|--------------------|--------|------|------|
| 50Hz | Output Shaft Speed | r/min | 8 | 7.5 |
| | Allowable Torque | N.m | 2.94 | 2.94 |
| | | kgf.cm | 30.0 | 30.0 |
| 60Hz | Output Shaft Speed | r/min | 10 | 9 |
| | Allowable Torque | N.m | 2.94 | 2.94 |
| | | kgf.cm | 30.0 | 30.0 |

Motor Overall Dimension

