

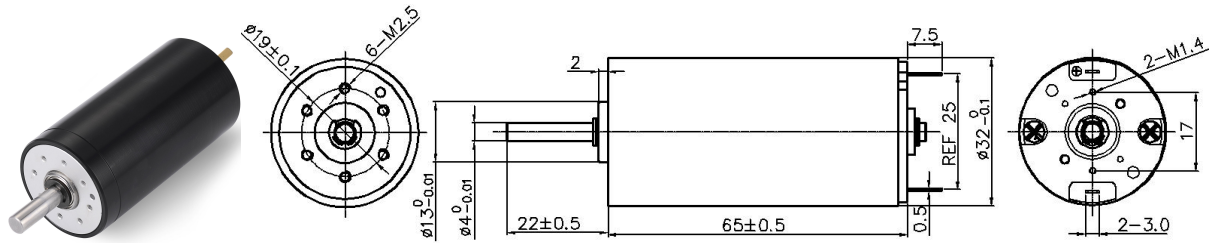

Coreless Graphite Brush Motor

LS-3265RC



Typical Applications: Meat slicer. DMS. Golf cart. Robot

电机参数 (Motor data)		01A	02A				
额定电压下数值 (Values at nominal voltage)							
1 额定电压 (Nominal voltage)	V	24	12				
2 空载转速 (No load speed)	rpm	5900	5200				
3 空载电流 (No load current)	mA	80	140				
4 额定转速 (Nominal speed)	rpm	5486	4940				
5 额定转矩(最大连续转矩) (Nominal torque)	mNm	30	20.7				
6 额定电流(最大连续电流) (Nominal current)	A	1.08	1.06				
7 堵转转矩 (Stall torque)	mNm	428.5	410.1				
8 堵转电流 (Stall current)	A	11.1	18.8				
9 最大效率 (Max efficiency)	%	84	85				
电机常数 (Motor constant)							
10 相间电阻 (Terminal resistance)	Ω	2.16	0.64				
11 转矩常数 (Torque constant)	mNm/A	38.07	21.60				
12 速度常数 (Speed constant)	rpm/V	246	433				

其他特性参数 Other characteristic parameters

13 环境温度范围 (Ambient temperature)	-10~40℃
14 绕组最高允许温度 (Max permissible winding temperature)	80℃
15 最高允许转速 (Max permissible speed)	10000rpm
16 电极磁极对数 (Number of the pole pairs)	1
17 换向器片数 (Number of the commutator segments)	13
18 电机质量 (Weight)	225g

01A电机曲线图 motor curve

